

## Side Mount Bracket Installation Instructions

Side mount bracket is only available for the arch window with blind width  $\leq 37"$ .

### Check Component / Hardware:

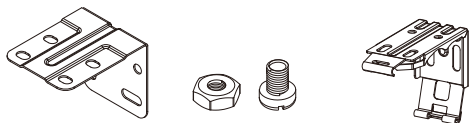

Side Mount Supporting Bracket    M4 Nut & Bolt    Installation bracket (For cordless blind)

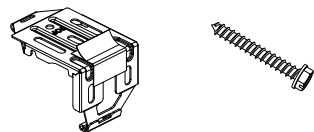

Installation bracket (For corded blind)    1 1/4" Screw



### Getting Started

NOTE: Prior to installation, please make sure your hands are clean and free from any dirt or oil that could cause damage to the blind.

#### Recommended Tools

- Measuring Tape
- Pencil
- Level
- Screwdriver
- Power drill (1/4" hex driver and drill bit)

You will need to use the following fasteners for your particular mounting surface.

Surface	Fastener
Wood	1 1/4" Hexagonal Head Screw (Provided) 
Drywall/Plaster	Wall Anchors, Expansion Bolts (Not Provided) 
Metal	Sheet Metal Screws (Not Provided) 

### Hardware Standard Quantity

Blind Width(X)	X $\leq$ 37"
Installation Bracket	2
1 1/4" Screw for Installation Bracket	4
Side Mount Supporting Bracket	2
M4 Nut&Bolt for Side Mount Supporting Bracket	4 sets

### How to assemble side mount bracket

**For Cordless Blind:** Align the side mount supporting bracket holes with the installation bracket holes, and then screw the M4 Nut & bolt into the **diagonal holes** for the left side mount bracket. Do the same for the right side mount bracket.

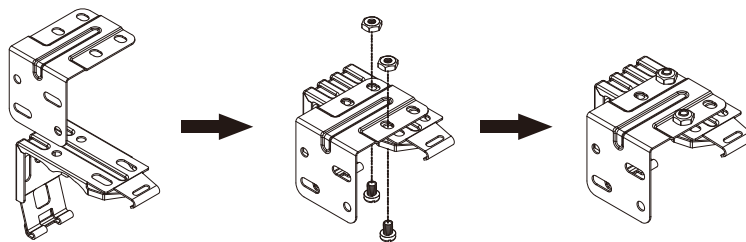

**For Corded Blind:** Align the side mount supporting bracket holes with the installation bracket holes, and then screw the M4 nut & bolt into the **outside holes** for the left side mount bracket. Do the same for the right side mount bracket.

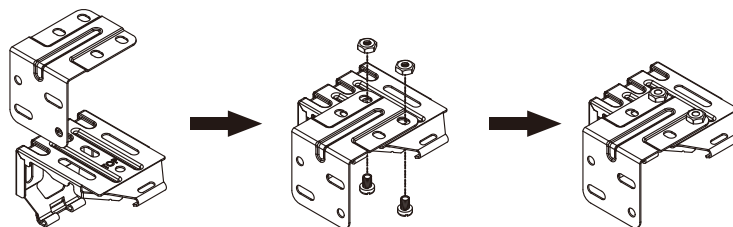

### How to install side mount bracket

Stick the bracket at the marked location and put two 1 1/4" mounting screws into the **diagonal holes** to secure bracket. Use wall anchors for drywall or plaster wall.

#### For Cordless Blind:

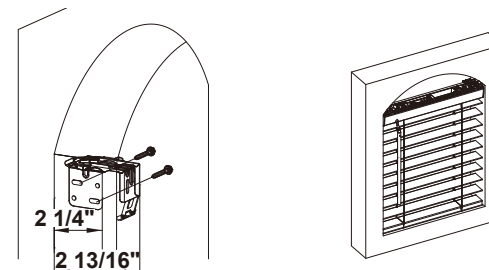

Side Mount Bracket Location

#### For Corded Blind:

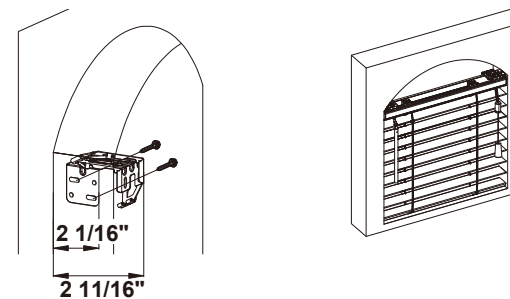

Side Mount Bracket Location

**Note:** For the blind installation, please refer to the installation instruction sheet in the hardware box.