

N300711-E Light Guard System Installation Instructions

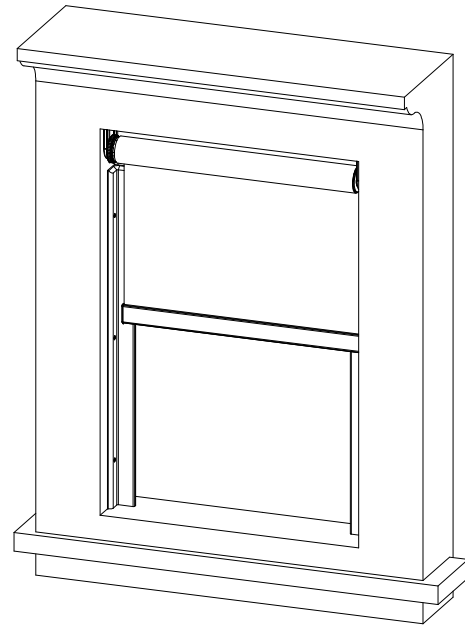

Recommended tools

- Power drill
- Tape measure
- Screwdriver
- Level ruler
- Pencil



Hardware included

Hardware	Drawing	Usage
3/4" round head screw		To install top light guard holder
1 1/2" flat head screw		To install wood light guard
3/4" flat head screw		To install aluminum light guard
Top light guard holder		To install top light guard
Raceway light guard holder		To install top light guard into raceway
Transparent Adhesive Tape		To join the spliced aluminum light guard
Aluminum light guard end cap		Pre-installed on the top of the aluminum light guard

Installation of Top Light Guard

For regular roller shade

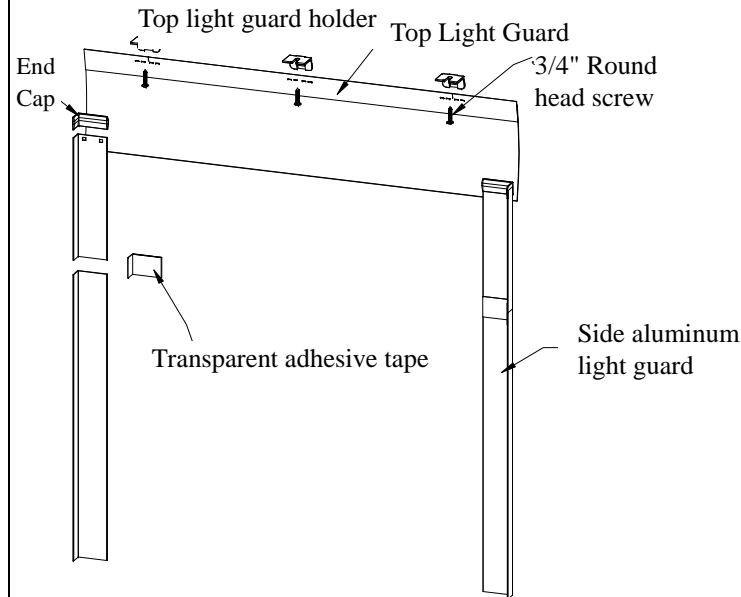
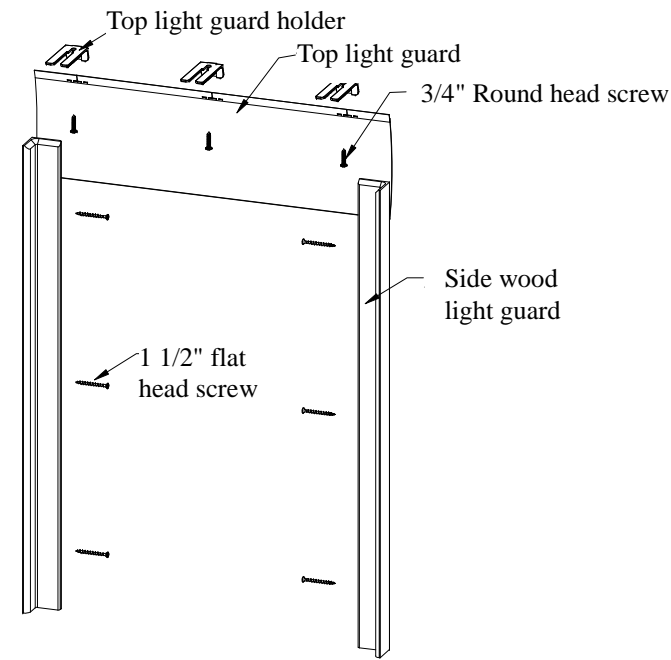

Install top light guard holder

Each top light guard holder needs one 3/4" round head screw for installation.

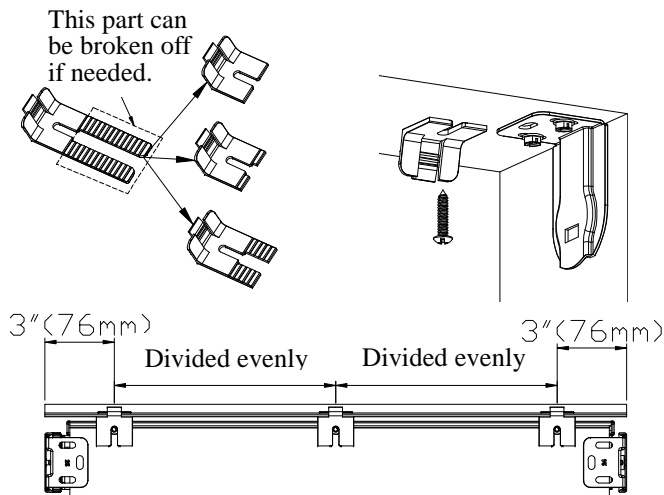

Install top light guard

Insert light guard to the back of top light guard holder and make sure the top of light guard meet the top of window firmly.

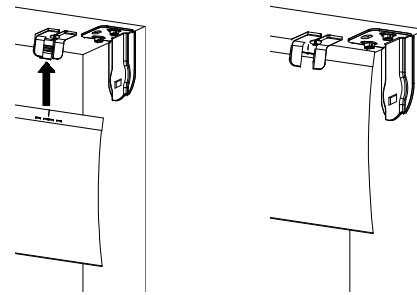

For roller shade with raceway system

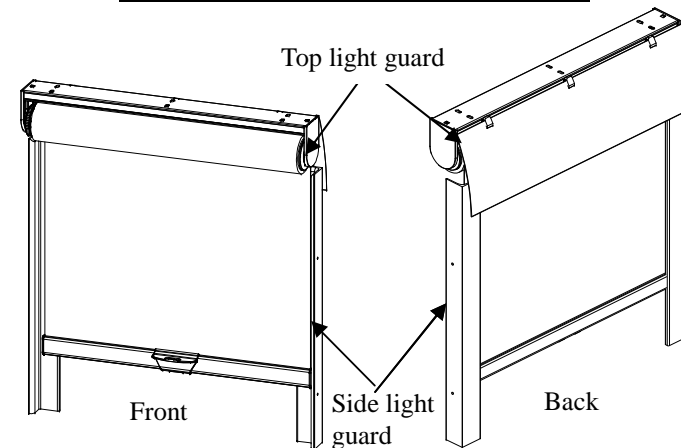

Install Top Light Guard

Insert the raceway light guard holder horizontally into the groove at the backside of raceway and turn 90 degrees to lock in the raceway groove. Then insert the top light guard into the groove of the raceway light guard holder.

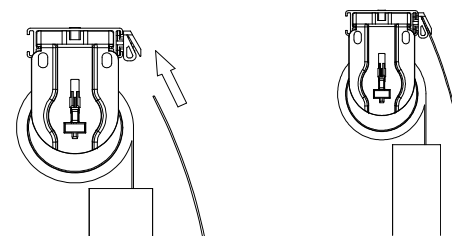
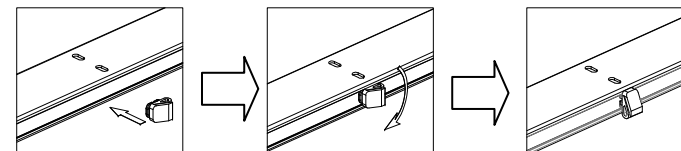

Installation of Side Light Guard

- Fully lower the shade down and make the wide side of light guard be next to the back of shade fabric.
- For aluminum light guard, tear off the double-side tape on the narrow side and stick the light guard to the window frame. For better fixing the aluminum light guard to the window, please use 3/4" flat head screw to secure the light guard through the pre-drilled hole.
- For wood light guard, use 1 1/2" flat head screw to install.
- For better light blocking, the top of light guard should be placed next to the shade fabric and the bottom of light block is recommend to be installed sloping to the front.

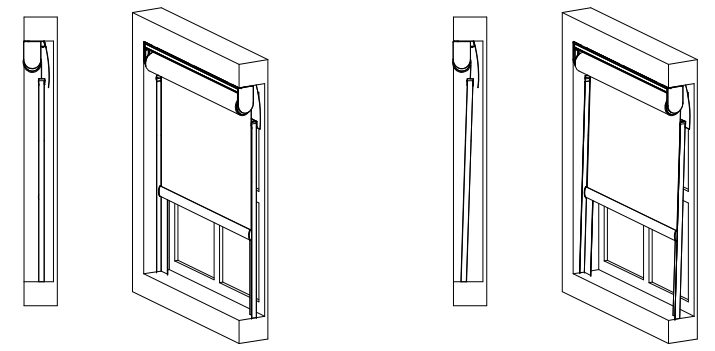

Installed vertically

Installed sloping

Installation of Transparent Adhesive Tape

Transparent adhesive tape is included for aluminum light guard length > 96" and spliced into 2 parts.

Installation: Align the double dotted line with the edge of the light guard, and fold the transparent adhesive tape on both sides, as shown in the figure below.

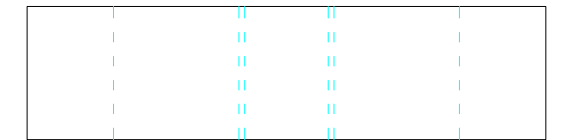

Transparent adhesive tape

