

Installation Instructions

Honeycomb Shades

SmartHome Motorized Cordless, Motorized Top Down

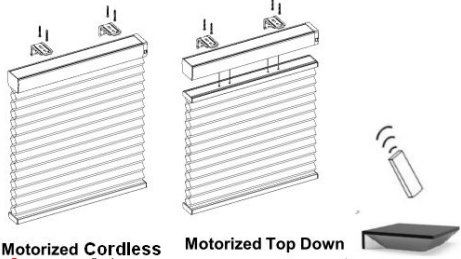

Motorized Cordless

Motorized Top Down

Getting Started

Remove shade from package. Save packaging until shade is installed and working to your satisfaction.

Tools:

- Level
- Measuring Tape
- Pencil
- Power drill (6mm hex driver and drill bit)
- Screwdriver



You will need to use the following fasteners for your particular mounting surface.

Surface	Fastener
Wood	Screws (Provide)
Drywall/Plaster	Wall Anchors, Expansion Bolts (Not Provide)
Metal	Sheet Metal Screws (Not Provide)

Check Component/Hardware:

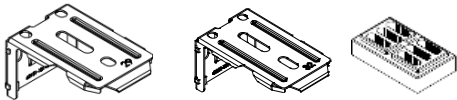

(3/8" Single, 1/2" Double,
9/16" Single, 3/4" Single)

(1 1/4" Single,
3/4" Double)

Spacer (Optional)

Installation Bracket

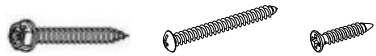

1 1/4" Installation
Screw

2" Screw
(Optional)

3/4" Screw
(Optional)



Hold Down bracket
(Optional)

Hardware Standard Quantity

Order Width (X)	$X \leq 56"$	$56" < X \leq 105"$	$X > 105"$
Installation Bracket	2	3	4
1 1/4" Screw (for Installation Bracket)	4	6	8
Spacer Block (Optional)	2	3	4
2" Screw (for Installation Bracket with 1~2pcs spacer block)	4	6	8
Hold Down bracket (Optional)	2	2	2
3/4" Screw (for Hold Down Bracket)	2	2	2

Note: Optional flat head screws included. Use as needed.

Step 1: Bracket Installation

- Measure 1 1/2" (40mm) from both ends of the head rail. Mark the bracket location on the mounting surface. Proper alignment of brackets will make installation easier.
- When shade width is less than 24", the distance from both ends of the headrail is 1 1/8" (30mm).

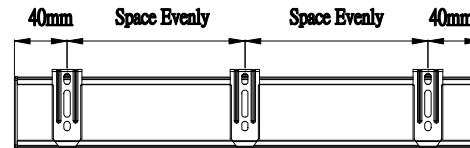

Inside Mount

Align the front of brackets 1/16" to the edge of window opening as below drawing. Use two 1 1/4" installation screws to secure brackets. Use wall anchors for drywall or plaster wall.

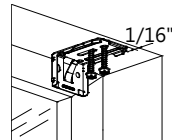

Outside Mount

Use two 1 1/4" installation screws to secure brackets. Use wall anchors for drywall or plaster wall.

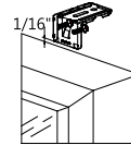

For 3/8" Single, 1/2" Double, 9/16" Single, 3/4" Single, allocate a min. distance of 1/16" from wall to the bottom of brackets as left drawing.

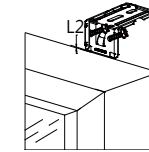

For 1 1/4" Single, 3/4" Double, allocate a min. L2 distance from wall to the bottom of bracket as left drawing. $0 \leq L2 \leq 1/4"$

Note: If spacer block is required, please follow this guide:

Please always make sure the raised side of the spacer block is against the bracket. Use 2" screws for one or two pcs of spacer blocks. See below pictures:

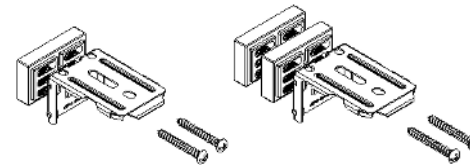

* For shallow mounting, using 2pcs of flat head screw to secure the bracket as below

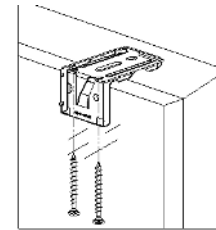

Step 2: Install the Shade

- Position head rail at an angle so that it is hooked to the front of the bracket. Then push it upward at the back to snap into the bracket.



For proper installation, start with attaching the front of the headrail to the bracket and ensure to stick right in place.

Note: You will hear a click sound once the head rail is properly secured.

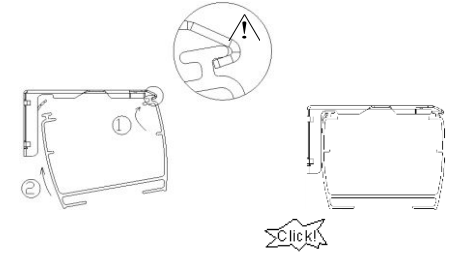

★ **Congratulations! You have finished installing the shade.**

How to Install Hold Down Brackets (optional)

A, For Hold Down Bracket.

- Use #6 3/4" screw to secure each bracket. Please fasten the screw tightly.

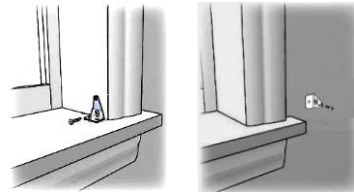

B. For Magnetic Hold Down

Use M3x15mm screw to secure the magnet catch at the below location. Make sure the magnet catch align with the pre-installed magnet on shade bottom rail.

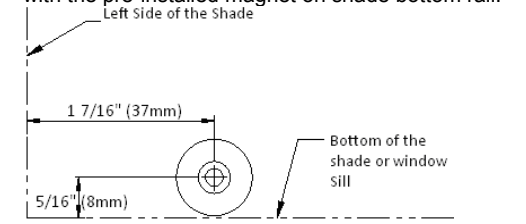

★ Shade Operation

Connect the battery wand or USB Wall Charger to the motor.

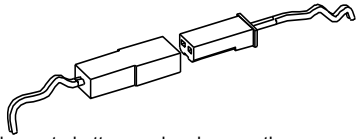

Install remote battery and make sure the screen shows the right channel for the shade, and then the shade can be operated. Please refer to the remote instructions for adjustment.

For BB 15-channel Remote Control: Use 1 Lithium battery CR2450 (3V) (supplied). There're total 15 channels available. The shade will be default pre-program in channel 1 unless specified at the factory before shipping. And the channel 0 is default to operate all. Limit 1 shade per channel.

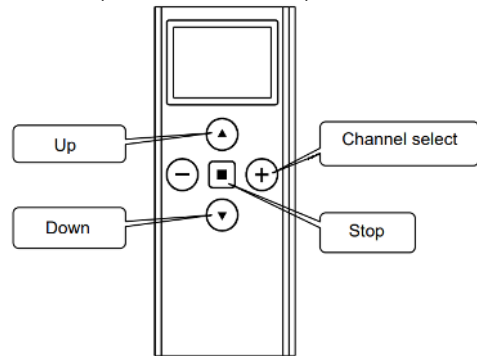

For RF 5-Channel Wall Switch: Use 1 Lithium cell battery CR2430 (3V) (supplied). There're total 5 channels available. The shade will be default pre-program in channel 1 unless specified at the factory before shipping.

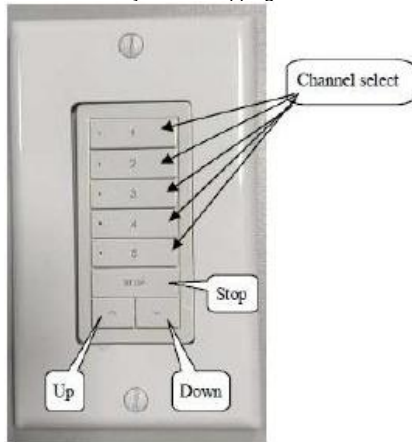

* Original status

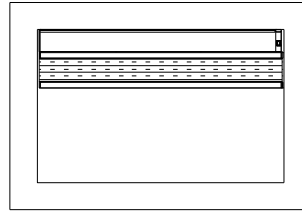

* Press DOWN, the middle rail & bottom rail will go down together.

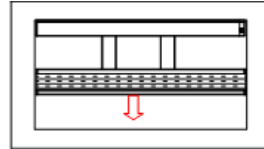

* When reach the bottom, the bottom rail will stop and the middle rail will go up.

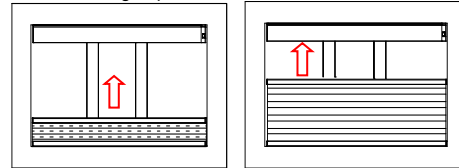

* When middle rail meet the head rail, it is drop limit.

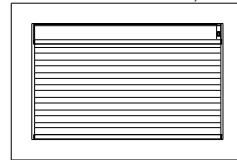

* Press UP, the middle rail will go down.

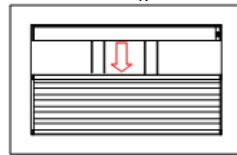

When the middle rail reach the bottom, the bottom rail & middle rail will go up together.

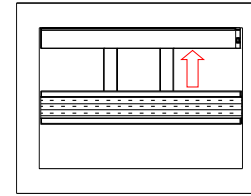
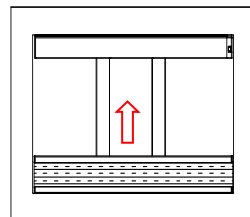

* When middle rail & bottom rail meet the head rail, it is top limit.

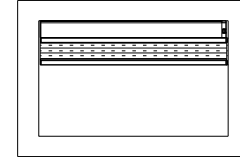

* When the shade stop at any location, if press STOP 3s, the middle rail will go to the middle of drop length.

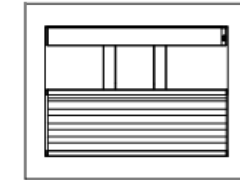

★ Remove the Shade

Fully raise the shade, and then gently pry the bracket off the head rail with a flat screwdriver. Remove the shade.

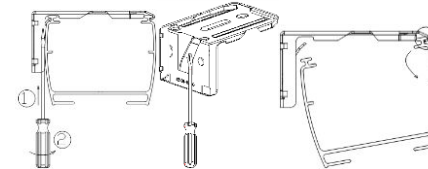

★ Manual Control Button

When remote is not available, the shade can be operated by the manual control button.



Do not press the manual control button over 4 secs.

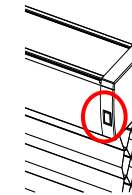

★ Note

Our remotes are pre-programmed and ready to use.

★ Cleaning the Shade

Routine cleaning will help maintain the beauty of your shade. The shade can be cleaned by using a soft brush, vacuumed with a low suction hand-held vacuum, cleaned ultrasonically (specify that a mild solution must be used and that the head rail should never be immersed in liquid). Spot cleaning is not recommended, but if necessary, dampen a clean cloth with a solution of warm water and mild detergent to dab at the spot until it's gone (do not rub!).



Do not spray the liquid to the electric parts of the motorized shade.

★ Troubleshooting

Problem	Solution
The shade will not snap into the mounting brackets	Check if mounting brackets are aligned. Refer to below drawing.
The shade will not lift	Check if all brackets are locked in place. Refer to below drawing.

Optional Parts Installation

Side Mount Bracket

Side mount bracket is only available for the arch window with shade width $\leq 37"$ and the normal bracket qty should be 2.



Hardware Standard Quantity

Shade Width (X)	$X \leq 37"$
Installation Bracket	2
1 1/4" Screw for Installation Bracket	4
Side Mount Supporting Bracket	2
M4 Nut & Bolt	4 sets

How to assemble side mount bracket

Align the side mount supporting bracket holes with the installation bracket holes, and then screw the M4 nut & bolt into the diagonal holes for the left side mount bracket. Do the same for the right side mount bracket.

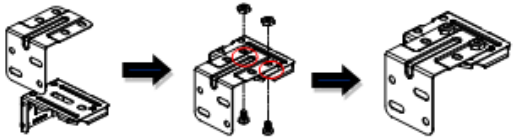

How to install side mount bracket

Put two 1 1/4" mounting screws into the diagonal holes to secure bracket. Use wall anchors for drywall or plaster wall.

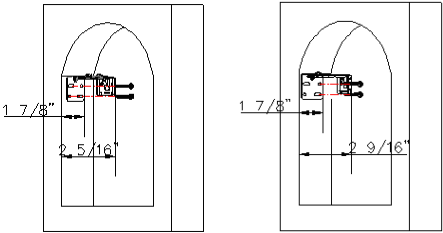

3/8" Single, 9/16" Single 1 1/4" Single, 3/4" Double
3/4" Single, 1/2" Double

Light Guard

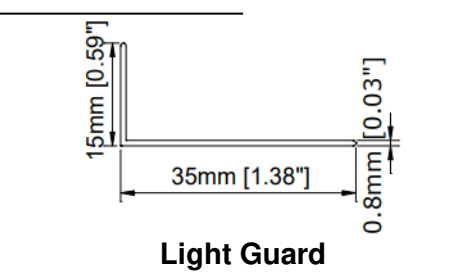

3/4" (M3.5x18.5mm) Flat Head Screw

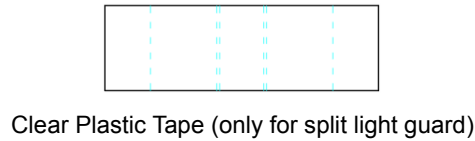

Install Light Guard (optional for IB)

Notice: To avoid scraping, leave at least 1/16" (2mm) gap between fabric stack and light guard.

The light guard is to be placed at back of the shade on left & right side.

- When the light guard length $\leq 96"$, place the light guard vertically towards the bottom window frame and then mark out the location with a pencil. Remove the double sided tapes and carefully paste the light guard in position. Fix 2pcs of 3/4" flat head screws to secure the light guard.

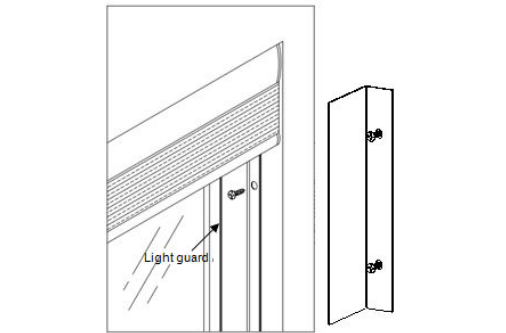

Note: The light guards on both sides are identical;

Use the double-sided tape on the narrow side of the light guard to attach to the window frame.

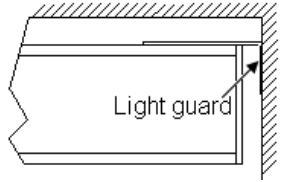

- When the light guard length exceeds 96", it will be spliced into 2pcs. Stick 2pcs of clear plastic tapes on both sides of the split part to seam the light guard. Place the light guard vertically towards the bottom window frame and then mark out the location with a pencil. Remove the double sided tapes and carefully paste the light guard in position. Fix 4pcs of 3/4" flat head screws to secure the light guard.

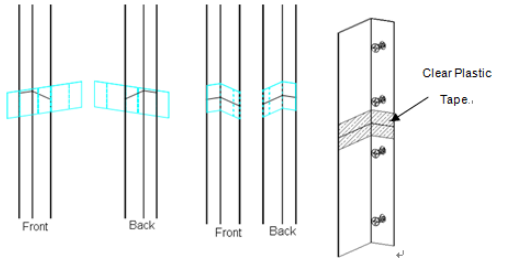



Note: We recommend that the seam be placed on top, shown in above drawings.