

Installation Instructions

Honeycomb Shades

AutoWand™ Motorized Bottom Up

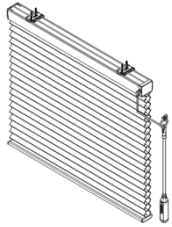

Note: Optional flat head screws included. Use as needed.

Step 1: Bracket Installation

- Measure 3" from both ends of the head rail. Mark the bracket location on the mounting surface. Proper alignment of brackets will make installation easier.

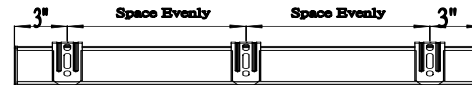

Inside Mount

Align the front of brackets 3/8" to the edge of window opening as below drawing. Use two 1 1/4" installation screws to secure brackets. Use wall anchors for drywall or plaster wall.

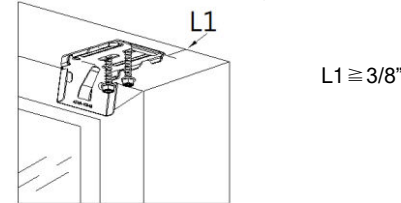

Outside Mount

Use two 1 1/4" installation screws to secure brackets. Use wall anchors for drywall or plaster wall.

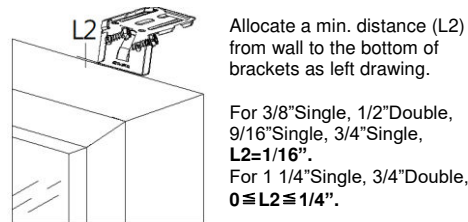

Note: If spacer block is required, please follow this guide:
Please always make sure the raised side of the spacer block is against the bracket.
Use 2" screws for one or two pcs of spacers. See picture below:

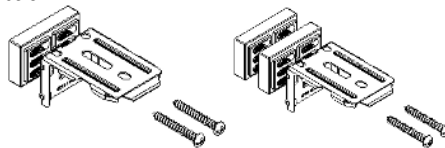

* For shallow mounting, using 2pcs of flat head screw to secure the bracket as below:

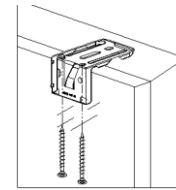

Step 2: Install the Shade

- Position head rail at an angle so that it is hooked to the front of the bracket. Then push it upward at the back to snap into the bracket.

▲ For proper installation, start with attaching the front of the headrail to the bracket and ensure to stick right in place.
Note: You will hear a click sound once the head rail is properly secured.

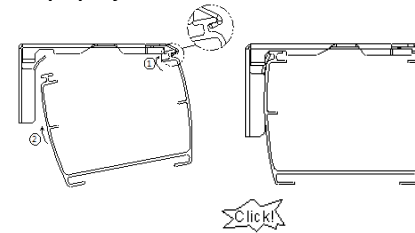

Step 3: Install the AutoWand™

A. Install the Hook.

After the shade is well installed, please mark the position where you will install the hook for the AutoWand™. Please make sure the AutoWand™ can connect to the motor after it is attached to the hook. Use one 3/4" (M3.5x18.5mm) Flat screw to fix the hook.



▲ To avoid interference, please install the hook outside the window frame and hang up the AutoWand™ as below drawing.

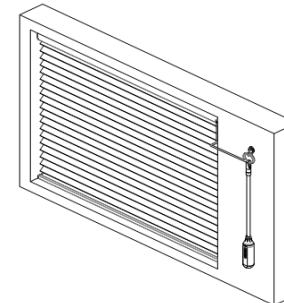

B. Operate the Shade

First please attach the AutoWand™ to the hook, and connect the cable port of end cap. Then press the **down** button to **turn on** the shade.

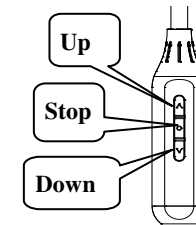
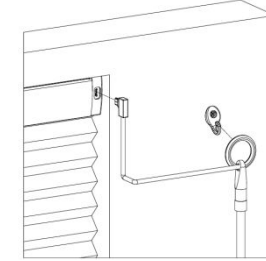

AutoWand™
(Control Wand)

★ **Congratulations! You have finished installing the shade.**

★ Recharge the AutoWand™

▲ **WARNING: Do not operate the shade while charging.**

If the shade moves with intermittent operation, it means low voltage of the battery. Charge the battery with 5V USB charger via the AutoWand™. When the battery is recharging, the indicator at the bottom of the AutoWand™ will flash red, and it will change to green light when the battery is fully charged.

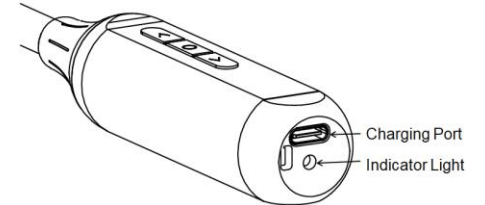

How to Install Hold Down Brackets (optional)

A. For Hold Down Bracket.

- Use #6 3/4" screw to secure each bracket. Please fasten the screw tightly.

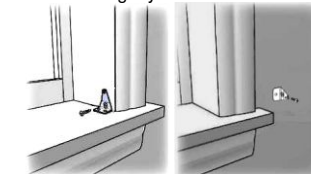

Getting Started

Remove shade from package. Save packaging until shade is installed and working to your satisfaction.

Tools:

- Level
- Measuring Tape
- Pencil
- Power drill (6mm hex driver and drill bit)
- Screwdriver



You will need to use the following fasteners for your particular mounting surface.

Surface	Fastener
Wood	Screws (Provide)
Drywall/Plaster	Wall Anchors, Expansion Bolts (Not Provide)
Metal	Sheet Metal Screws (Not Provide)

Check Component/Hardware:



Installation Bracket

X ≤ 56" x 2pcs
56" < X ≤ 105" x 3pcs
105" < X ≤ 120" x 4pcs
(X=Order Width)

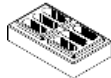

Spacer Block (Optional)

1pc for extend distance 3/8"
2pcs for extend distance 11/16"

Installation bracket
qty x 2pcs

#8 1 1/4" Hexagon Screw
for Installation Bracket

2" Screw for Installation Bracket
with Spacer Block (Optional)



Hold Down bracket (Optional)

x 2pcs

#6 3/4" Screw for Hold
Down Bracket (Optional)

x 2pcs

B. For Magnetic Hold Down

- Use M3x15mm screw to secure the magnet catch at the below location. Make sure the magnet catch align with the pre-installed magnet on shade bottom rail.

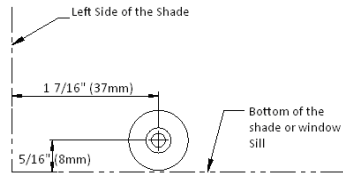

★ Remove the Shade

Fully raise the shade, and then gently pry the bracket off the head rail with a flat screwdriver.

Remove the shade.

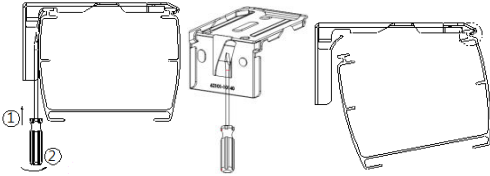

★ Cleaning the Shade

Routine cleaning will help maintain the beauty of your shade. The shade can be cleaned by using a soft brush, vacuumed with a low suction hand-held vacuum, cleaned ultrasonically (specify that a mild solution must be used and that the head rail should never be immersed in liquid). Spot cleaning is not recommended, but if necessary, dampen a clean cloth with a solution of warm water and mild detergent to dab at the spot until it's gone (do not rub!).

⚠ Do not spray the liquid to the electric parts of the motorized shade.

★ Troubleshooting

Problem	Solution
The shade will not snap into the mounting brackets	Check if mounting brackets are aligned. Refer to below drawing.
The shade will not lift	Check if all brackets are locked in place. Refer to below drawing.

Optional Parts Installation

Side Mount Bracket

Side mount bracket is only available for the arch window with shade width $\leq 37"$ and the normal bracket qty should be 2.



Side Mount Supporting Bracket



M4 Nut & Bolt



1 1/4" Screw

Hardware Standard Quantity

Shade Width (X)	$X \leq 37"$
Installation Bracket	2
1 1/4" Screw for Installation Bracket	4
Side Mount Supporting Bracket	2
M4 Nut & Bolt	4 sets

How to assemble side mount bracket

Align the side mount supporting bracket holes with the installation bracket holes, and then screw the M4 nut & bolt into the diagonal holes for the left side mount bracket. Do the same for the right side mount bracket.

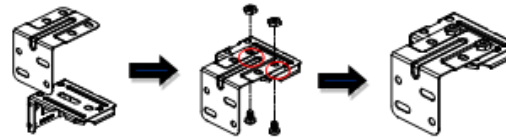

How to install side mount bracket

Put two 1 1/4" mounting screws into the diagonal holes to secure bracket. Use wall anchors for drywall or plaster wall.

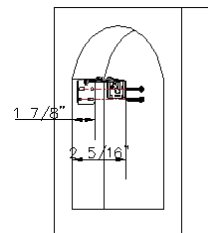

3/8" Single, 9/16" Single
3/4" Single, 1/2" Double

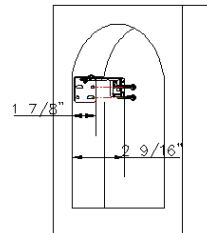

1 1/4" Single, 3/4" Double

Light Guard

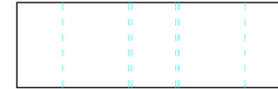
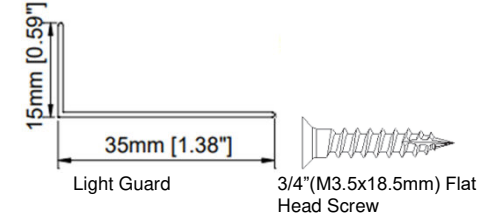

Clear Plastic Tape (only for split light guard)

Install Light Guard (optional for IB)

Notice: To avoid scraping, leave at least 1/16" (2mm) gap between fabric stack and light guard.

The light guard is to be placed at back of the shade on left & right side.

- When the light guard length $\leq 96"$, place the light guard vertically towards the bottom window frame and then mark out the location with a pencil. Remove the double sided tapes and carefully paste the light guard in position. Fix 2pcs of 3/4" flat head screws to secure the light guard.

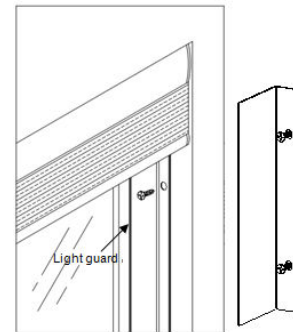

Note: The light guards on both sides are identical;

Use the double-sided tape on the narrow side of the light guard to attach to the window frame.

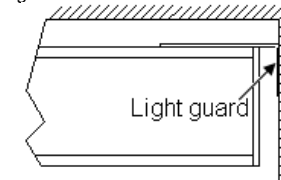

- When the light guard length exceeds 96", it will be spliced into 2pcs. Stick 2pcs of clear plastic tapes on both sides of the split part to seam the light guard.

Place the light guard vertically towards the bottom window frame and then mark out the location with a pencil. Remove the double sided tapes and carefully paste the light guard in position. Fix 4pcs of 3/4" flat head screws to secure the light guard.

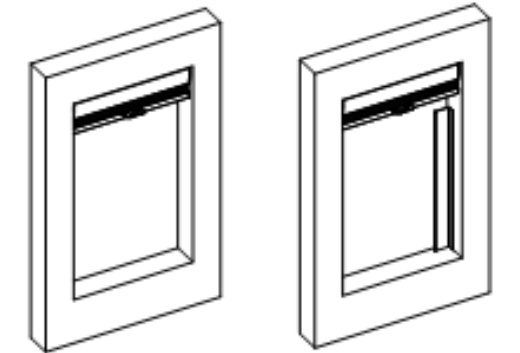
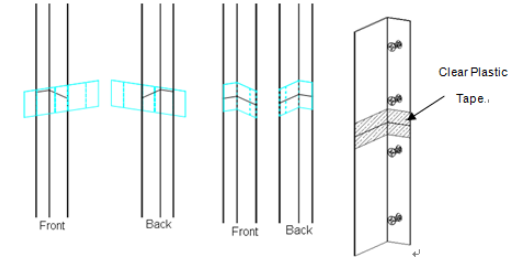

Note: We recommend that the seam be placed on top, shown in above drawings.